

Retro Grinder - Parallel

Unit 8 Willows Business Park Shelley Huddersfield
West Yorkshire England HD8 8LU
T. +44 (0)1484 600560 F. +44 (0)1484 600570
email: info@rollertech.co.uk

www.rollertech.co.uk

Wizard 1™ & 2™

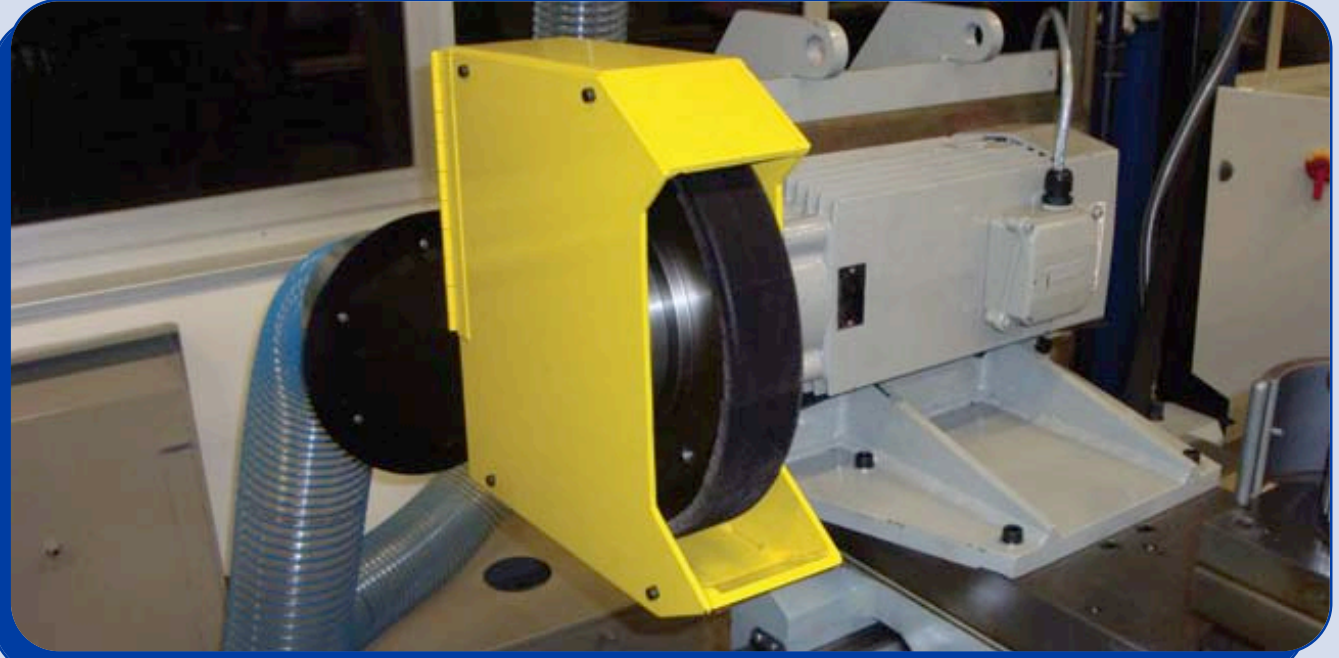

Wizard 1™

Available with 7.5 / 11.0kW variable motors.
(upto 5800 rpm) Suitable for 350mm Wheels.

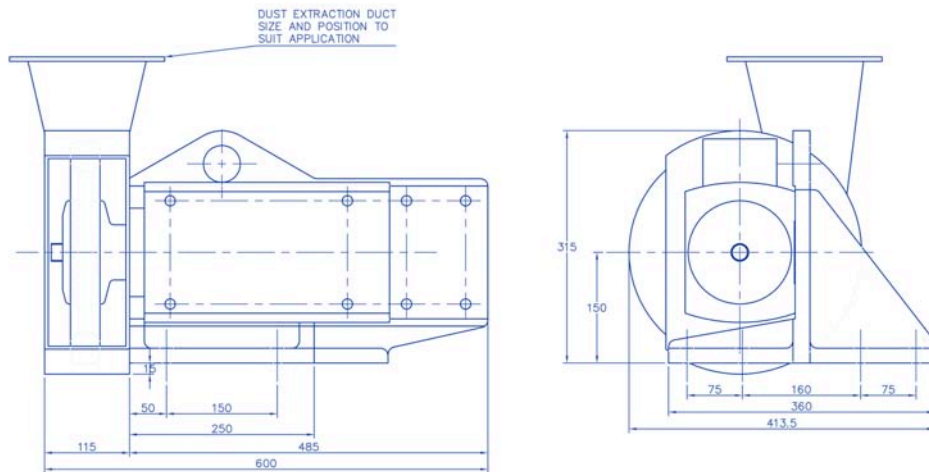

Retro Grinder - Parallel

Wizard 1™ & 2™

Performance

The Wizard 1™ and 2™ are specially designed grinding attachments for retrofitting to any type of centre lathe for grinding parallel rubber rollers.

Robust but lightweight in construction, this new design utilised the latest CAD system and provides enhanced performance with greater rigidity. In addition it places less stress on the lathe slide way systems than its old-fashioned overweight competitors.

The Wizard 1™ and 2™ are powered by a 7.5kw or 11kw motor. Both are special high torque, 2 pole, 2800rpm motors.

For even greater flexibility, the Wizard 2™ offers the same two sizes of motor power, but with an infinitely variable, inverter drive with grinding wheel speeds from 500 – 5800rpm selectable in 1 rev increments. This allows for the fine tuning of the wheel speed when grinding rollers of differing diameters.

Whichever model of Wizard™ you choose you'll find it compact, therefore unlikely to interfere with any normal turning operations when not in use. It is easy to fit and usually carried out by our customers in their own works.

Reliability and test - many hundreds of hours of exhaustive testing went into the development of the Wizard™ grinding attachment. On completion of build each unit also successfully completes several hours of tests before being given the Rollertech seal of approval - so you can be confident you will receive the best quality and most reliable product on the market today.

Technical Specification

7.5kW (10hp) or 11kW motors (15hp)

Wizard 1 features special hi-torque 2 pole 2800rpm motors

Wizard 2 an infinitely variable inverter drive with a maximum speed of 5800rpm and is supplied with electrical panel and isolator.

Wheel guard as standard

Operator instruction manual

Set electrical schematics

380/415V AC 50/60Hz

7.5kW – 25amps

11kW – 30amps

Options

Installation/commissioning/training is available in your own works. We can also source a quality new or used lathe for the fitment of your Wizard grinding attachment.

Painted to customers specifications

Wheel specification – 350 x 60 x 127mm bore

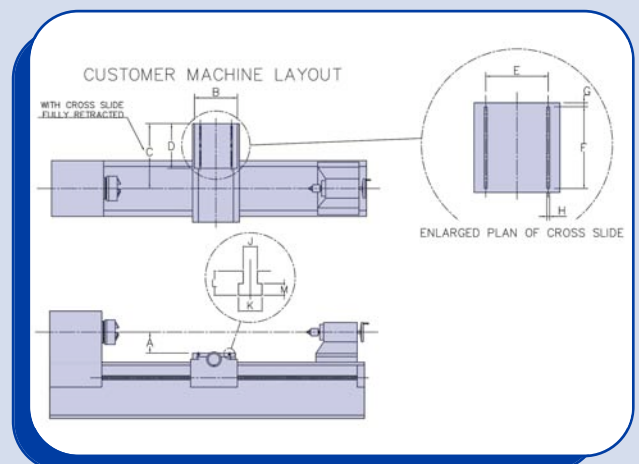

Order Form

A:	mm	G:	mm	MAXIMUM DIAMETER CAPACITY:
B:	mm	H:	mm	
C:	mm	J:	mm	MAXIMUM CROSS SLIDE TRAVERSE:
D:	mm	K:	mm	
E:	mm	L:	mm	POWER SUPPLY:
F:	mm	M:	mm	